

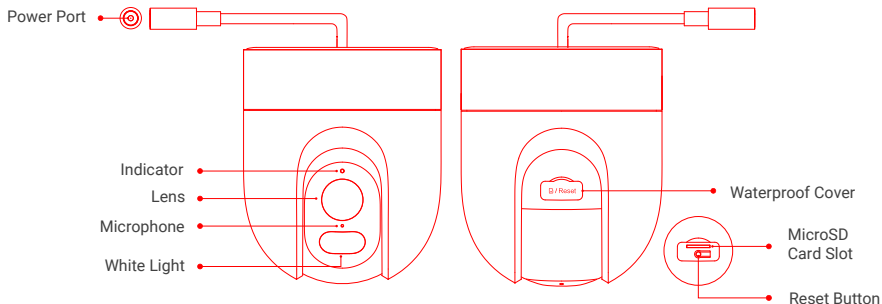

Read this manual carefully before use, and retain it for future reference.

Product Overview



Package Contents: Xiaomi Outdoor Camera CW400, power adapter, wall mount, waterproof tape for power cable, wall/ceiling mounting template sticker, screw accessory kit, user manual

Note: Illustrations of product, accessories, and user interface in the user manual are for reference purposes only. Actual product and functions may vary due to product enhancements.

● Installing a microSD card

Make sure that the camera is unplugged. Open the waterproof cover above the microSD card slot and insert a microSD card with its contact points facing down.

CAUTIONS: Unplug the camera before installing or removing the microSD card. Please use a microSD card from a qualified brand (the camera supports a microSD card with a maximum capacity of 256 GB and the FAT32 format, only, and a microSD card with capacity of 64 GB or above may need to be formatted to the FAT32 format before use by going to Settings > Storage settings on the camera's plug-in page in the Mi Home/Xiaomi Home app). It is recommended that the microSD card has a read/write speed of no less than U1/Class 10.

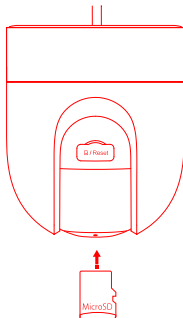

Note: After installing or removing the microSD card, make sure to place the waterproof cover back on the card slot properly to prevent water from entering the camera and affecting normal use.

● Turning on

- Insert the power adapter cable into the power port to automatically turn on the camera.

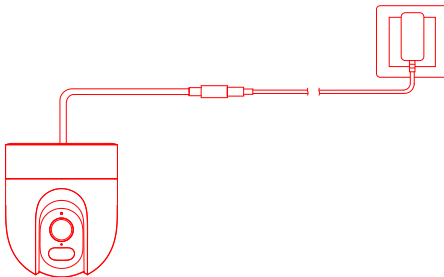

- The camera is successfully turned on when the indicator light is yellow and a voice prompt is heard.

Notes: Please make sure to use the original power adapter cable for connection to avoid abnormal operations. Do not twist the lens of the camera to force it to rotate after the camera is turned on. If the lens is not positioned accurately, you may calibrate it via the Mi Home/Xiaomi Home app.

● Indicator status description

Yellow: Awaiting connection...

Blinking yellow: Connecting to a network...

Blinking blue: Connecting to a server...

Keeping blue: Connected successfully

Connecting with the Mi Home/Xiaomi Home App

This product works with the Mi Home/Xiaomi Home app*. Use the Mi Home/Xiaomi Home app to control your device, and to interact with other smart home devices.

Scan the QR code to download and install the app. You will be directed to the connection setup page if the app is installed already. Or search for "Mi Home/Xiaomi Home" in the app store to download and install it.

Open the Mi Home/Xiaomi Home app, tap "+" on the upper right, and then follow the instructions to add your device.

*The app is referred to as Xiaomi Home app in Europe (except for Russia). The name of the app displayed on your device should be taken as the default.



4882C916

Note:

The version of the app might have been updated, please follow the instructions based on the current app version. Make sure that the camera turns on and the network connection is stable during connecting. The indicator keeps yellow when the camera is turned on, and then changes to blue after the successful connection between the camera and the app.

● Resetting

Press the reset button if changing the network or the Xiaomi Account connected to the camera. A voice prompt will be heard once the reset is completed.

Note: Resetting the camera will not delete any data on the microSD card.

Precautions

- The operating temperature for the camera ranges from -30 °C to 60 °C. Do not use the camera in environments with temperatures above or below the specified range.

- The camera is a precision electronic product that has an IP66 dust-tight and water-resistant rating. To ensure normal use, do not use the camera in extremely humid environments or locations that may cause water ingress.
- The power adapter that comes along with the camera is not waterproof and is only for indoor use. Do not use the power adapter in extremely humid environments or locations that may cause water ingress. The operating temperature for the power adapter ranges from -30 °C to 45 °C. Do not use in environments with temperatures above or below the specified range.
- To improve camera's performance, do not place it where its lens faces or is next to a reflective surface, such as glass and white walls, as this will cause the image to appear overly bright in areas close to the camera and darker in areas further away, or may cause the camera to produce white images.
- When using Wi-Fi, please make sure that the camera is installed in an area with a strong Wi-Fi signal. Do not install the camera near microwave ovens or other objects or places that may affect its Wi-Fi signal.
- If the power cable is damaged or broken, it must be replaced by professionals from the manufacturer, after-sales service department, or departments of similar functions to avoid safety hazards.

How to Install

Mounting the camera on a wall

1. Turn the camera bottom up, align it with the locating points on the mount, and screw into the holes.

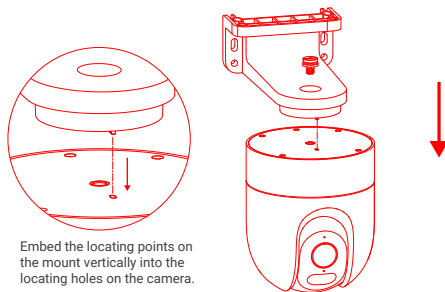

2. Paste the mounting template sticker where the camera needs to be installed, and drill four holes in the wall with a drilling tool according to the locating holes on the sticker. The hole is approx. 6 mm in diameter and approx. 40 mm in depth.

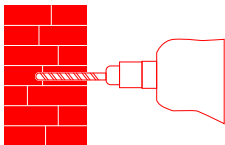
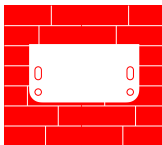

3. Insert four plastic wall plugs into the holes in the wall.

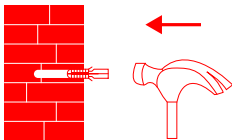

4. Place the mount against the wall, insert screws into the holes, and drill them into the plastic wall plugs on the wall.

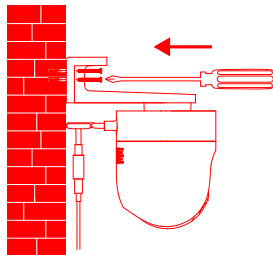

Wall mount installation

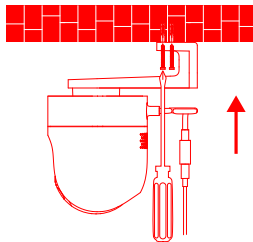

Ceiling mount installation

5. Wrap the power cable port with the waterproof tape after the camera is fixed to ensure waterproof performance.

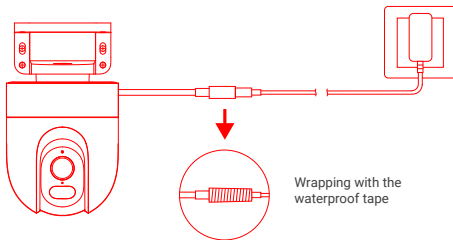

CAUTIONS:

- The wall must be able to support at least three times the total weight of the camera.
- The camera must be firmly fixed to the wall according to the installation instructions in the user manual to prevent accidental injury.
- Do not install near an air conditioner outdoor unit, range hood outlet, gas water heater outlet, or other heat sources.

Specifications

Name: Xiaomi Outdoor Camera CW400

Model: MJSXJ04HL

Rated Input: 12 V  1 A

Aperture: F1.6

Video Codec: H.265

Operating Temperature: -30 °C to 60 °C

Resolution: 2560 x 1440

Item Dimensions: 98 x 98 x 117 mm

Lens Viewing Angle: 113°

Wireless Connectivity: Wi-Fi IEEE 802.11b/g/n 2.4 GHz

Storage: MicroSD card

Compatible with: Android 8.0™ & iOS 12.0 or above

Operating Frequency: 2412 - 2472 MHz

Maximum Output Power: < 20 dBm

External Power Supply: Charge the device with the EU adapter (AD-0121200100EU-6) supplied by Shenzhen AMC Technology Co., Ltd.

WARRANTY NOTICE

As a Xiaomi consumer, you benefit under certain conditions from additional warranties. Xiaomi offers specific consumer warranty benefits which are in addition to, and not instead of, any legal warranties provided by your national consumer law. The duration and conditions related to the legal warranties are provided by respective local laws. For more information about the consumer warranty benefits, please refer to Xiaomi's official website <https://www.mi.com/global/support/warranty>. Except as prohibited by laws or otherwise promised by Xiaomi, the after-sales services shall be limited to the country or region of the original purchase. Under the consumer warranty, to the fullest extent permitted by law, Xiaomi will, at its discretion, repair, replace or refund your product. Normal wear and tear, force majeure, abuse or damage caused by the user's negligence or fault are not warranted. The contact person for the after-sale service may be any person in Xiaomi's authorised service network, Xiaomi's authorised distributors or the final vendor who sold the products to you. If in doubt please contact the relevant person as Xiaomi may identify.

The present warranties do not apply in Hong Kong and Taiwan.

Products which were not duly imported and/or were not duly manufactured by Xiaomi and and/or were not duly acquired from Xiaomi or a Xiaomi's official seller are not covered by the present warranties. As per applicable law you may benefit from warranties from the non-official retailer who sold the product. Therefore, Xiaomi invites you to contact the retailer from whom you purchased the product.

Regulatory Compliance Information

WEEE Information



All products bearing this symbol are waste electrical and electronic equipment (WEEE as in directive 2012/19/EU) which should not be mixed with unsorted household waste. Instead, you should protect human health and the environment by handing over your waste equipment to a designated collection point for recycling of waste electrical and electronic equipment, appointed by the government or local authorities. Correct disposal and recycling will help prevent potential negative consequences to the environment and human health. Please contact the installer or local authorities for more information about the location as well as terms and conditions of such collection points.

EU Declaration of Conformity



Hereby, Tianjin Hualai Technology Co., Ltd. declares that the radio equipment type MJXJ04HL is in compliance with Directive 2014/53/EU. The full text of the EU declaration of conformity is available at the following internet address:
<http://www.mi.com/global/service/support/declaration.html>

It is recommended to use LPS power supply, or the PS Level of power output part is less than PS2.
Under normal use of condition, this equipment should be kept a separation distance of at least 20 cm between the antenna and the body of the user.

Manufactured for: Xiaomi Communications Co., Ltd.
Manufactured by: Tianjin Hualai Technology Co., Ltd.
(a Mi Ecosystem company)

Address: 8/F, Huaqiao Chuangye Building, No. 10 Jinping Road, Ya'an Road, Nankai District, Tianjin, China

For further information, please go to www.mi.com

User Manual Version: V1.0

Importer:
Beryko s.r.o.
Pod Vinicemi 931/2, 301 00 Plzeň
www.beryko.cz